

Output CA Ø40
Input CA Ø11

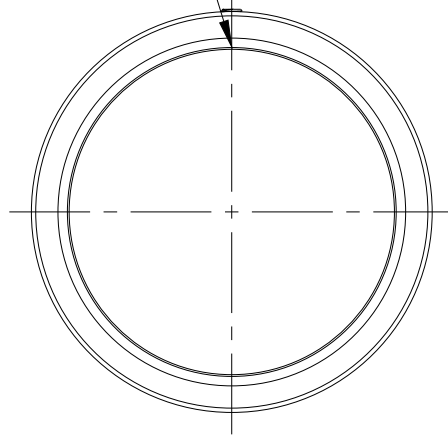

Ring for setting expansion

input

Ø36

Ø50.8 [2in]

Lock screws
2 x M3x0.5
HEX 1.5mm screwdriver

Ring for setting divergence

Ø53

output

THREAD SM2
2.035"-40

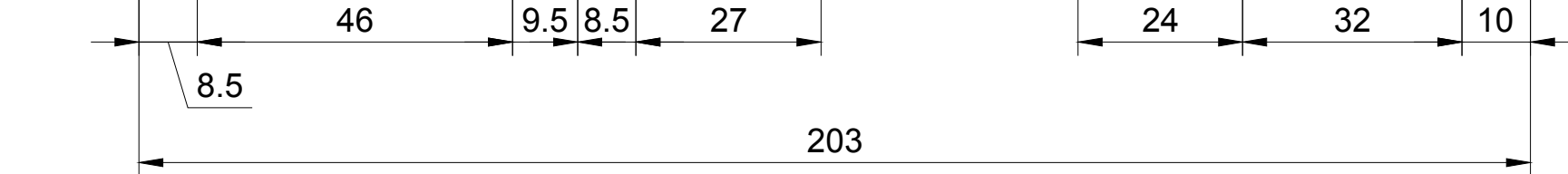

FOR INFORMATION ONLY
NOT FOR MANUFACTURING PURPOSES

Dept.	Technical reference 1:1.5	Created by 26/06/2018	Approved by
		Document type	Document status
		Title VEX18v3.1 1.0x - 8.0x variable expander	DWG No. VEX18v3.1
		Rev.	Date of issue
			Sheet 1/1